

A:\2024\24-0055-001-01 1501 Atlantic Fleet Wash Truck Wash\Drawings\24-0055-LP.dwg [LP-1] Feb 25, 2025 5:21pm NPASTRE

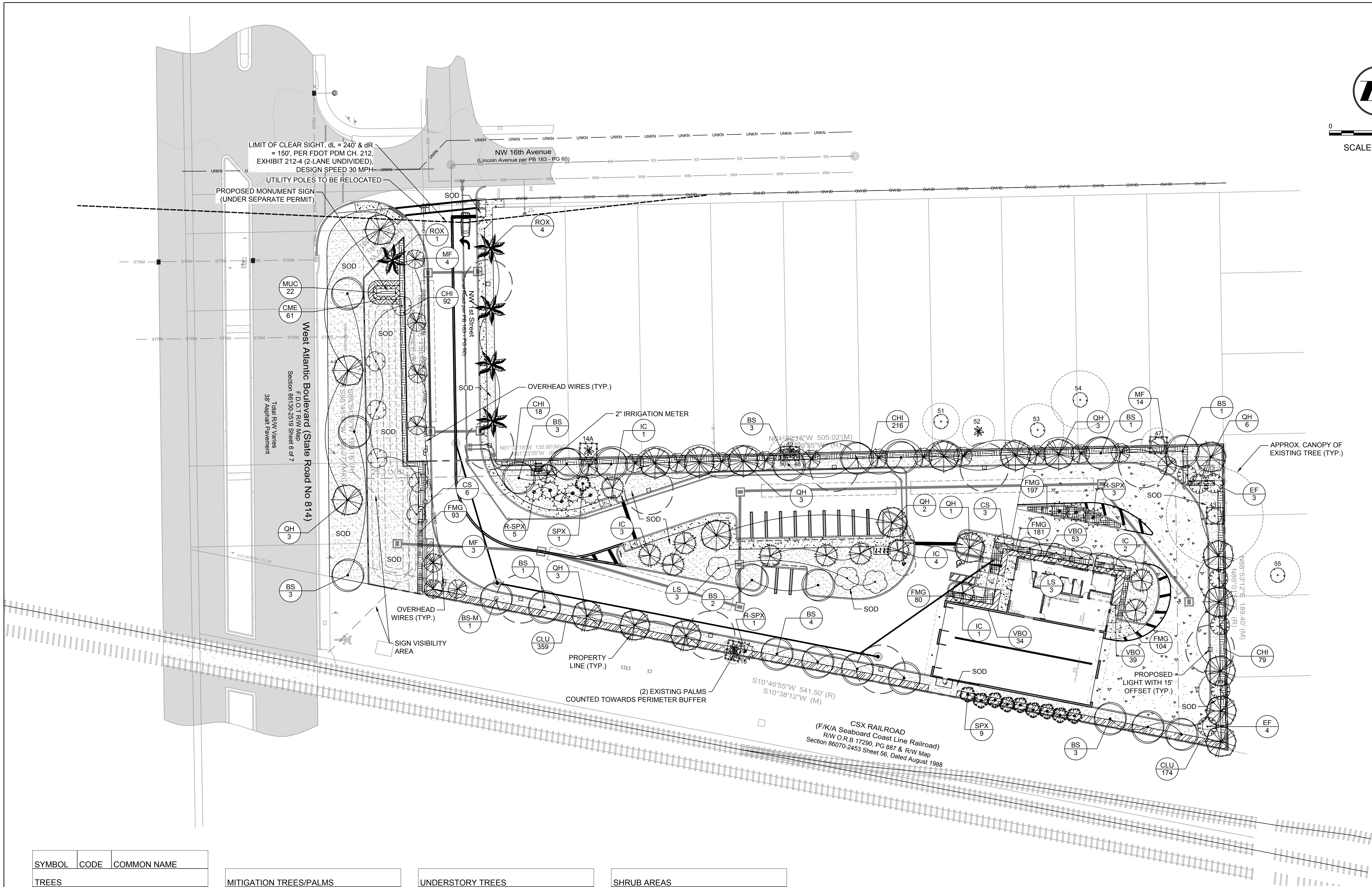

SYMBOL	CODE	COMMON NAME
TREES		
	IC	Dahoon Holly
	BS	Gumbo Limbo
	QH	Highrise Live Oak
	CS	Silver Buttonwood
	LS	Tuskegee Crape Myrtle

MITIGATION TREES/PALMS		
	BS-M	Gumbo Limbo
PALM TREES		
	ROX	Florida Royal Palm
	SPX	Sabal Palm

UNDERSTORY TREES		
	MF	Simpson's Stopper
	EF	Spanish Stopper
PALMS		
	R-SPX	RELOCATED Cabbage Palm

SHRUB AREAS		
	VBO	Dwarf Walter's Viburnum
	CME	Emerald Blanket Carissa
	FMG	Green Island Ficus
	MUC	Pink Muhly
	CHI	Red Tip Cocoplum
	CLU	Small-Leaf Clusia
SOD/SEED		
	SOD-1	Floritam St. Augustine Sod

SEE FULL SCHEDULE ON SHEET LP-2

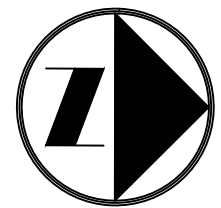

SCALE: 1" = 30'

DATE:	02/26/25
SCALE:	AS SHOWN
DESIGN BY:	AKR
DRAWN BY:	AKR
CHECKED BY:	NDP
APPROVED BY:	SWP

CRAVEN THOMPSON AND ASSOCIATES, INC.
ENGINEERS • PLANNERS • SURVEYORS
35653 N.W. 53RD STREET, FORT LAUDERDALE, FLORIDA 33309
TEL: (954) 739-6409
FAX: (954) 739-6409
FLORIDA LICENSED ENGINEERS, SURVEYORS & MAPPING BUSINESS NO. 2771
FLORIDA LICENSED LANDSCAPE ARCHITECTURE BUSINESS NO. C000114
RECEIVED 02/26/25

ATLANTIC FLEET WASH
1501 WEST ATLANTIC BLVD.
POMPANO BEACH, FLORIDA
PREPARED FOR:
KAJA PROPERTIES INC.
LANDSCAPE PLAN

Nicole D. Pastre
Florida R.L.A. No. 6667397
2025-02-25
PROJECT NO.
24-0055-001-01
LP-1
SHEET ____ OF ____

DRC

PZ24-12000026

04.02.2025